

# The AI Agent Office Map

A No-Panic Guide to Understanding Your Technical Infrastructure

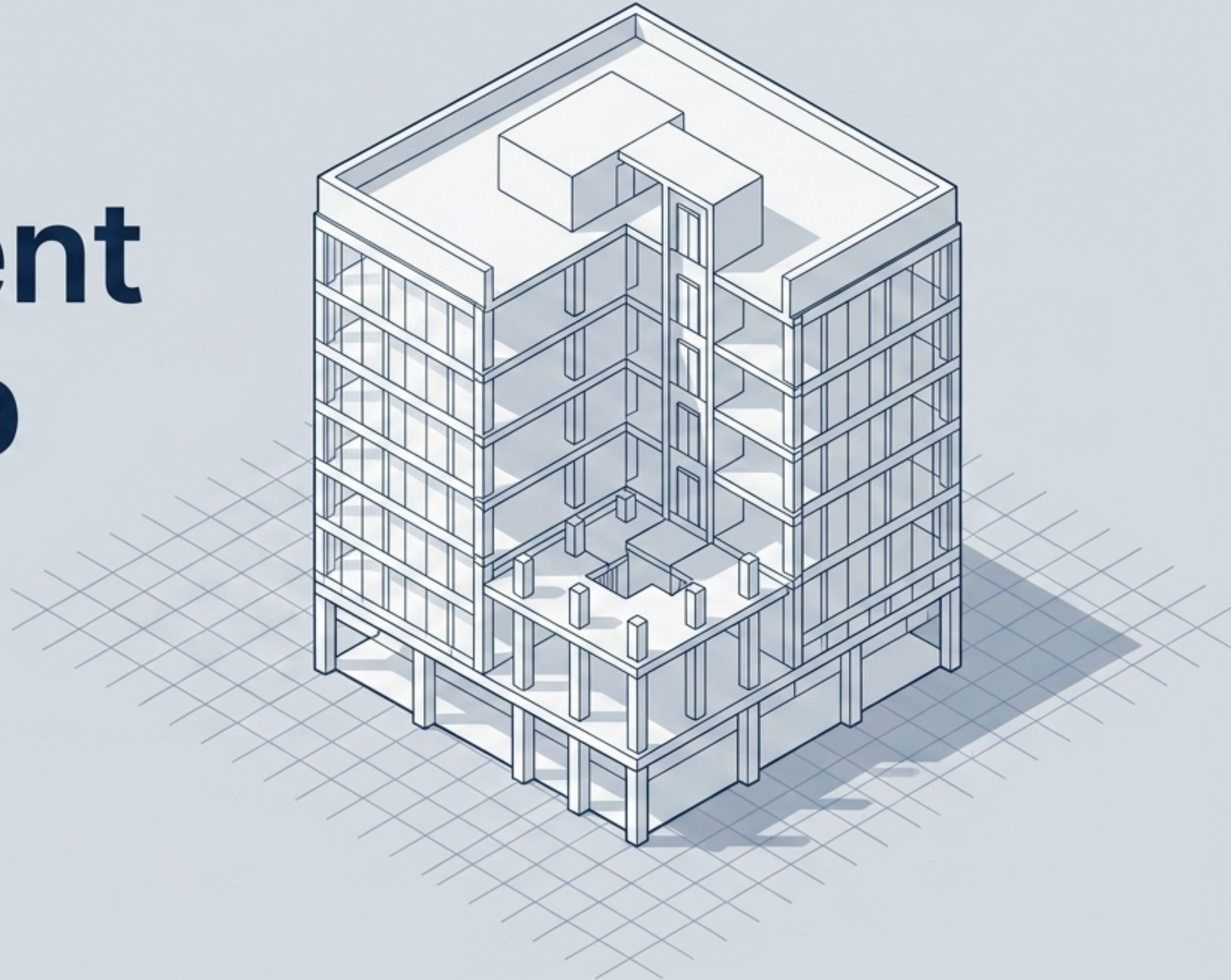

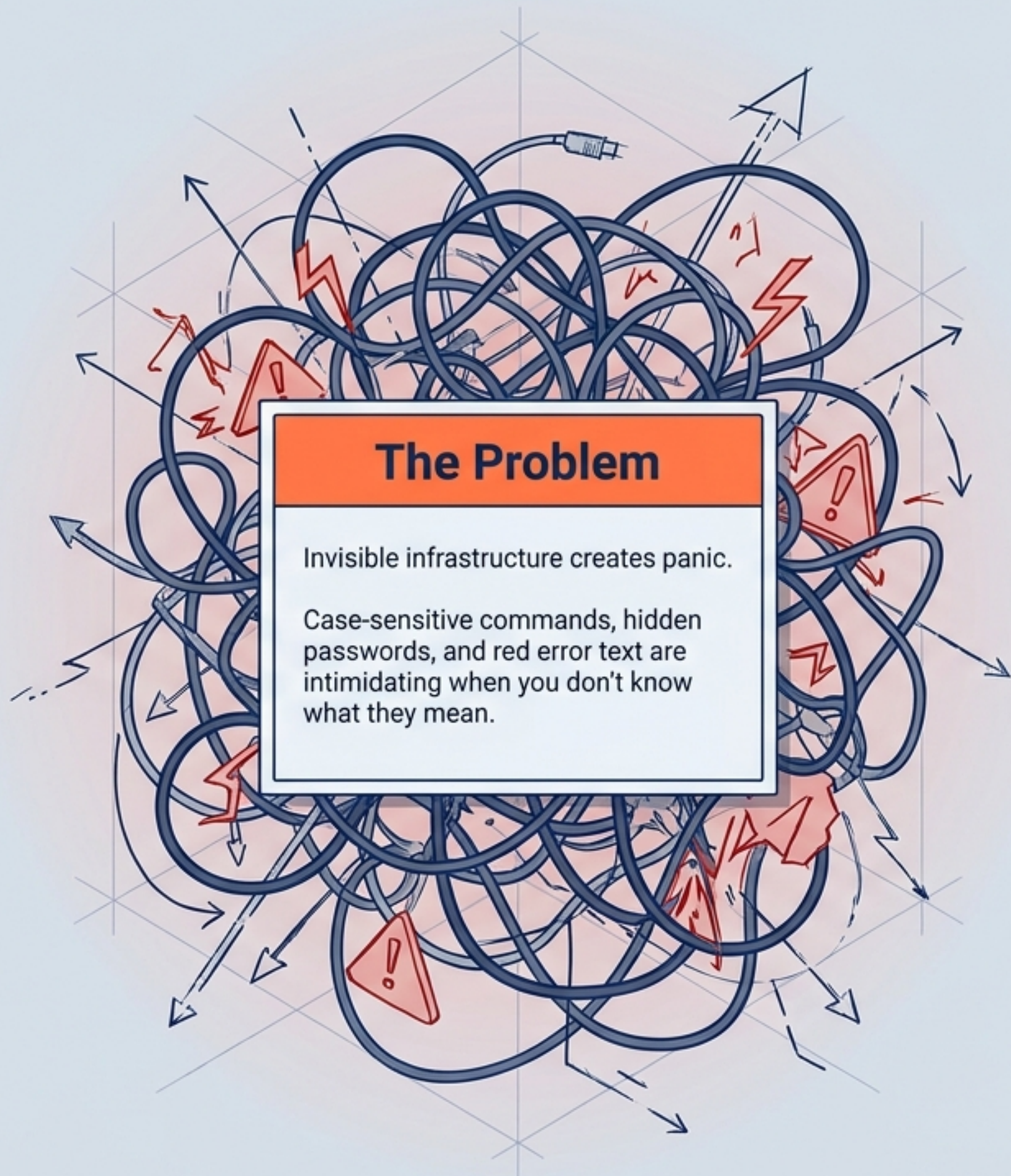

# The Office Blueprint: How Everything Connects

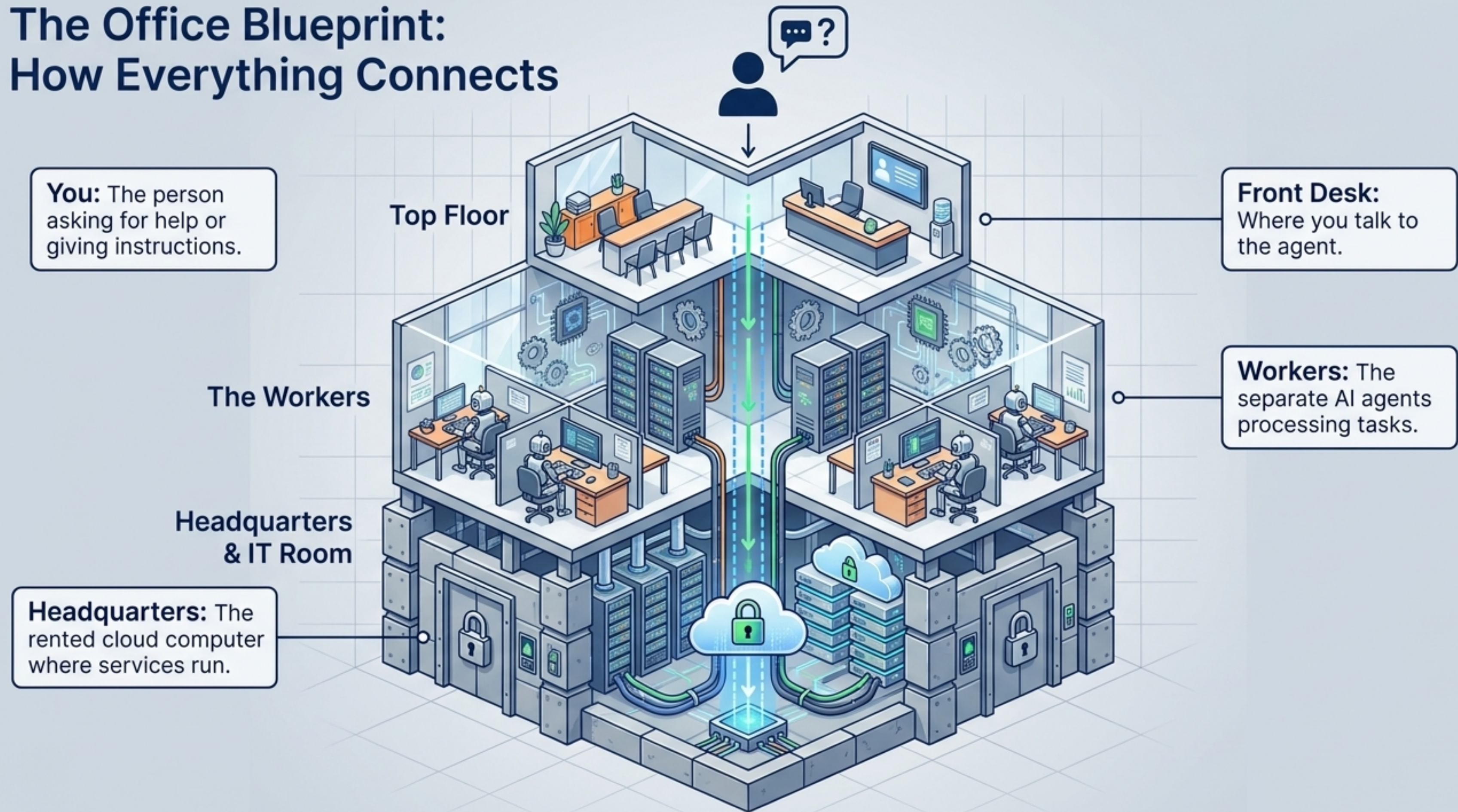

# The Front Desk Manages All Communication



**Metaphor:** The Front Desk

**Tech Term:** Telegram

**Why it Matters:** A clean messaging app used as the chat interface where you talk to the agent.

**Metaphor:** The Receptionist

**Tech Term:** Telegram Bot

**Why it Matters:** A small program inside Telegram that listens for your messages and passes them to the agent.

**Metaphor:** Receptionist Password

**Tech Term:** Bot Token

**Why it Matters:** A secret code proving your bot is the real receptionist. If wrong, the receptionist cannot log in.

# The Workforce Executes Your Instructions



Middle Floors

**Metaphor:** The Workers

**Tech Term:** Hermes & OpenClaw

**Why it Matters:** These are two separate, distinct AI agent systems that the user currently employs to process tasks.

**Metaphor:** Access Badge

**Tech Term:** API Key

**Why it Matters:** A secret credential that lets your agent talk to an outside AI service. If the badge expires, the agent cannot think or reply.

# Headquarters Keeps the Business Running 24/7

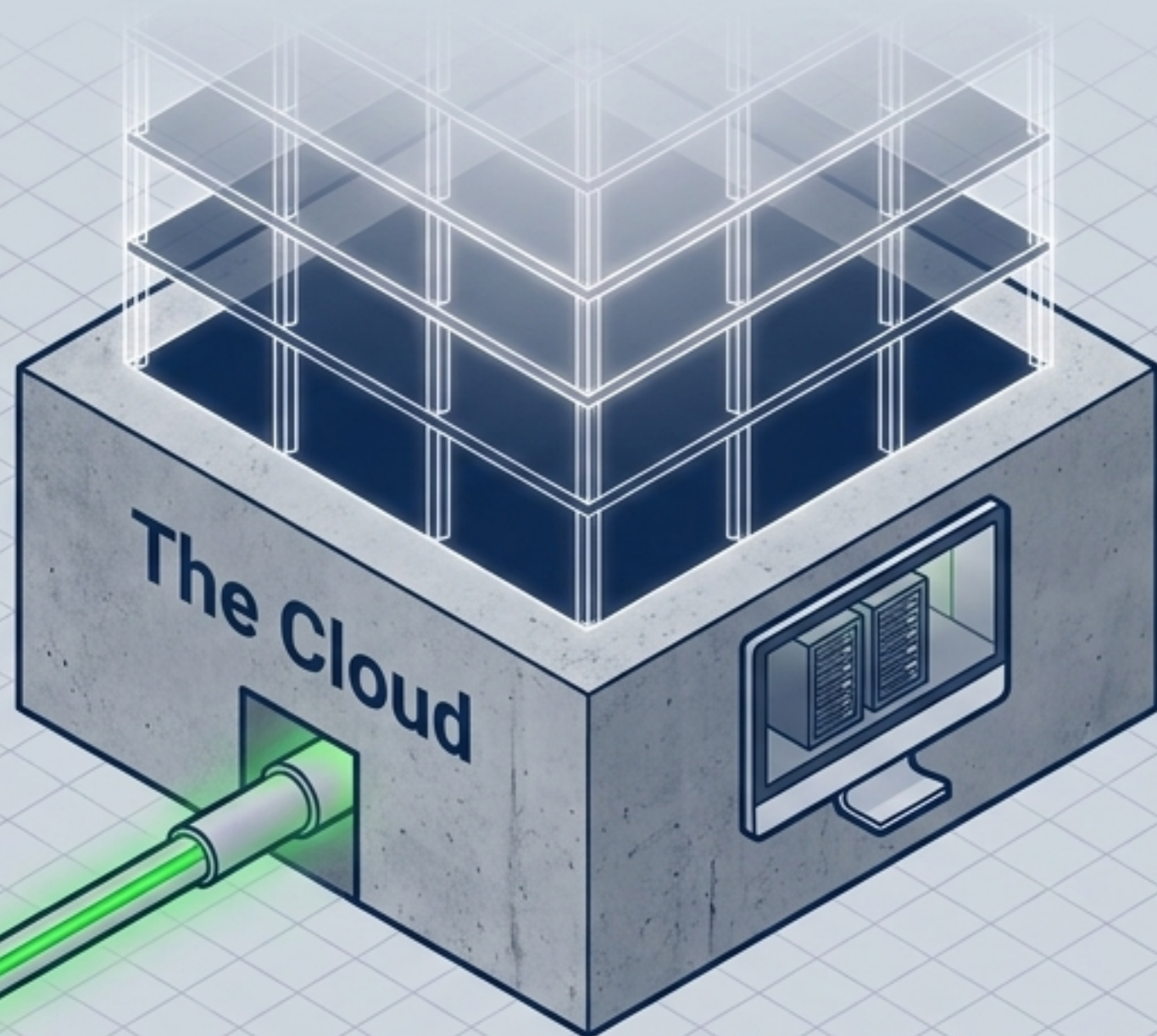

## Metaphor: "Headquarters"

**Tech Term:** "VPS (Virtual Private Server)"

**Why it Matters:** "A rented computer in the cloud. Your AI agent services run here all day, even when your personal laptop or phone is turned off."

## Common Mistake:

Thinking the VPS is a program. It is not. It is the physical/virtual computer where the programs live.

# The Engine Room Manages Internal Logistics

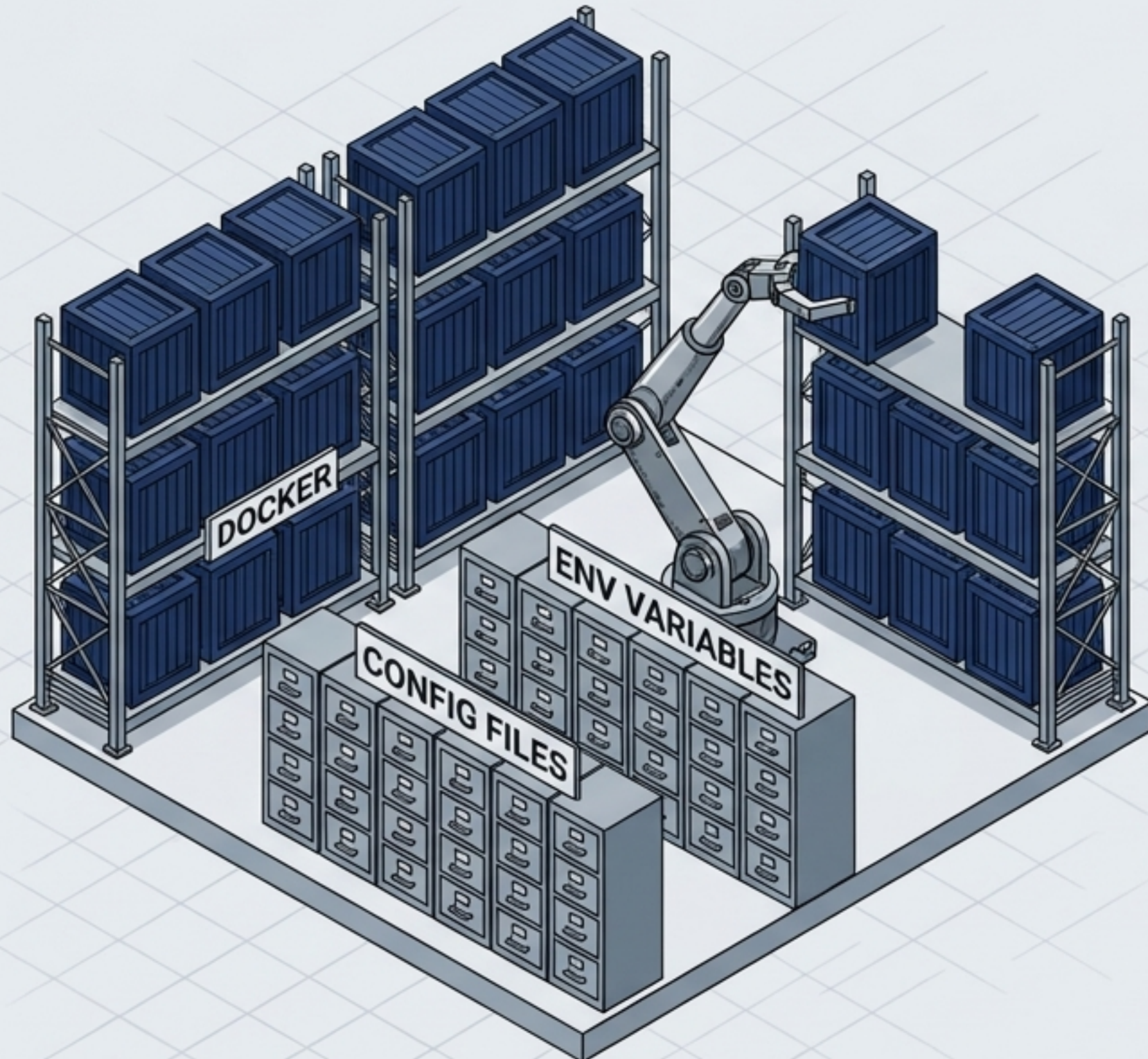

**Metaphor:** "Shipping Container"  
**Tech Term:** "Docker"

**Why it Matters:** "A boxed environment containing everything an agent needs, reducing 'it works on my machine' errors."

**Metaphor:** "Background Worker"  
**Tech Term:** "Service / Daemon"

**Why it Matters:** "A program running continuously. If it stops, the agent stops until restarted."

**Metaphor:** "Rulebook & Hidden Drawers"  
**Tech Term:** "Config Files & Environment Variables"

**Why it Matters:** "Where settings and invisible tokens live. A missing drawer or a typo in the rulebook stops the agent from starting."

# Secure Tunnels Bypass the Open Internet

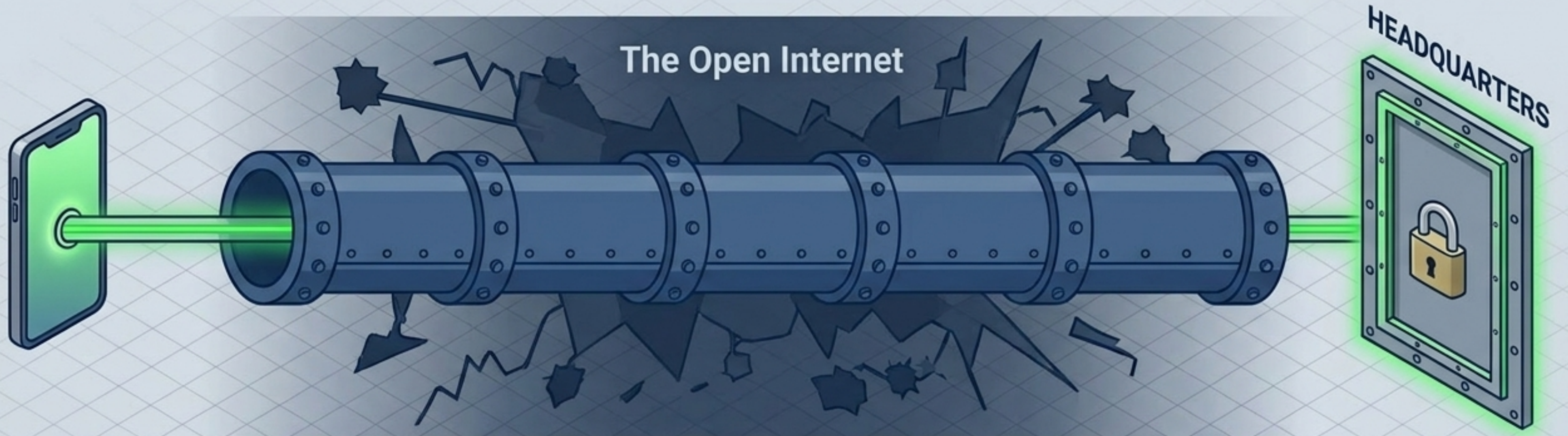

**Metaphor:** "Private Hallway"

**Tech Term:** "Tailscale"

A secure tunnel connecting your devices privately so only you can reach Headquarters. If closed, connection fails.

**Metaphor:** "Staff Entrance Key"

**Tech Term:** "SSH"

A **secure** way to unlock and enter Headquarters remotely. Without it, you cannot reach the IT Room.

**Metaphor:** "Security Guard & Door Number"

**Tech Term:** "Firewall & Port"

The system that blocks unwanted traffic from entering specific entry points.

# The IT Room Gives You Complete Control

**Metaphor:** "The IT Room"

**Tech Term:** "Terminus"

**Why it Matters:** "The repair app on your phone/computer that connects you to the Command Desk when the Front Desk is broken."

**Metaphor:** "Command Desk"

**Tech Term:** "Terminal"

**Why it Matters:** "A text-based workspace where you type repair commands. It looks plain but is powerful."

**Metaphor:** "Security Camera"

**Tech Term:** "Logs"

**Why it Matters:** "Text records of activity. When something breaks, this "footage" tells you exactly what happened."



# Emergency Procedures Fix Temporary Issues

BREAK GLASS IN CASE OF EMERGENCY

**Metaphor:** "Clock Out / Clock Back In"

**Tech Term:** "Restart"

**Why it Matters:** Stopping and starting a service to clear temporary problems. This fixes many issues safely without altering any settings.



**Metaphor:** "Emergency Copy"

**Tech Term:** "Backup"

**Why it Matters:** A saved copy of settings you can restore. Turns disasters into minor inconveniences.

# Diagnostic Matrix: When Things Break

Office Role	Technical Tool	What Happens If It Breaks?
Receptionist	Telegram Bot	Your messages never reach the agent.
Receptionist Password	Bot Token	The bot cannot log in to receive messages.
Access Badge	API Key	The agent cannot think or reply to you.
Private Hallway	Tailscale	Your personal connection to Headquarters fails.
Staff Entrance Key	SSH	You are locked out of the IT Room and cannot fix things.
Background Worker	Daemon	The agent stops responding completely until restarted.

# Anatomy of a Message: Tracing a Single Action

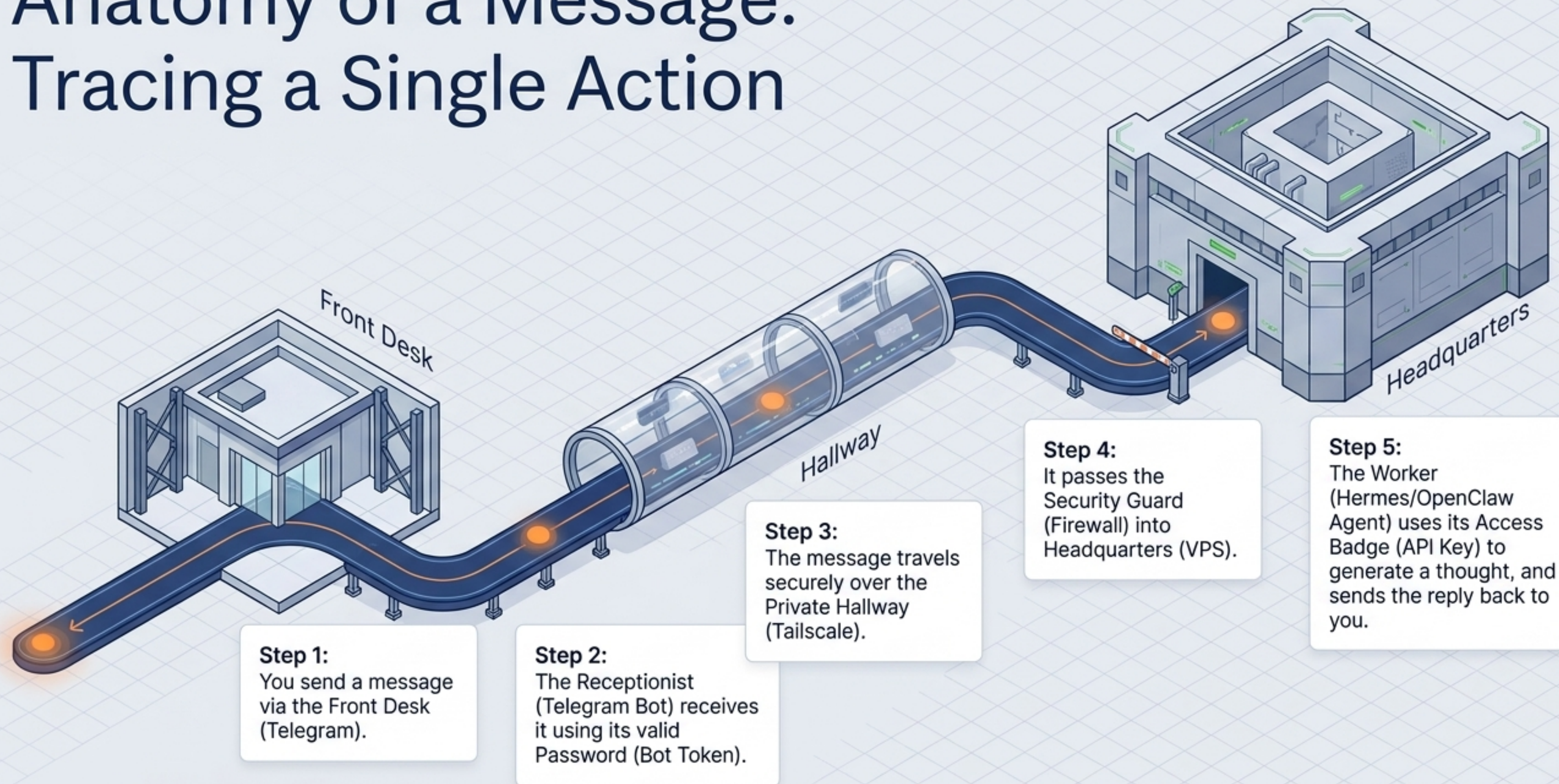

# You Now Have the Mental Map to Manage Your Agents

If you understood this, you are on the right track:



Telegram is where you talk to the agent.

Hermes and OpenClaw are separate AI agents.

Termius is where technical repair work happens.

Tailscale is a private connection, similar to a VPN.

A VPS is a rented cloud computer where agent services can run.

You have the vocabulary. You are ready to manage your infrastructure without panic.